

World War Two At Home (Q&A)

Notes for Teachers

Before your visit we would be grateful if you could **divide the class into 3** roughly equal groups, each with an adult or teacher in charge. Please **number the groups 1 to 3**. Each adult will need a copy of the enclosed map/adult helper information sheet.

On arrival the children will be met and shown where to put their coats. They then need to **go to the activity which corresponds to their group number** (Group 1 goes to Activity 1 etc.)

At least two of the activities will be supervised by museum personnel or helpers; for all the others **easy instructions will be available** at the relevant location. The group needs to remain at its activity for about **20 minutes**; museum personnel will let you know when it's time to move on and which activity to go to next.

Activity 1: *Wartime People*

The children will have a range of objects/clothes to handle to find out more about the people who owned them and life on the home front.

Activity 2: *Clothes Rationing*

Find out about clothes rationing in the setting of our 1940s clothes shop. Can you work out what evacuees were allowed to take with them and how many coupons everything would cost?

Activity 3: *Gas Attacks*

Find out all about gas masks and gas attacks. Will they work out which mask is which? See real gas masks and try on a replica one.

Activity 4: *Q&A with WW2 Veterans*

This is an opportunity to talk to volunteers who lived through the Second World War. Encourage the class to think of questions that they can ask them. But remember, most of our volunteers were only young when the war started, so try and come up with some really good questions that they can answer.

We hope you enjoy your visit

World War Two At Home (KS2) (3 Acts +Q&A) Notes for Helpers

You will be in charge of a small group of children and will be escorting them around the museum. **Along with this sheet you will need a copy of the map** with numbers on (showing where each activity will take place).

Every 20 minutes the group will move to a different part of the museum to start a new activity. **There are 3 activities**, as detailed below. Museum staff will let you know when it is time to move on and which activity to go to next. **Look for the arrows** to help you find your way to the next activity.

If you are with Group 1 you will start at Activity 1, Group 2, Activity 2 and so on. When it is time to move on, move your group to the next activity with the next number (after Activity 3 you will move to Activity 1). When activities 1—3 are finished the whole group will do activity 4.

There will be a box or a coloured wallet at each activity location. **Please read the instructions** and help the children to complete the task..

Activity 1: *Wartime People*

The children will have a range of objects/clothes to handle to find out more about the people who owned them and life on the home front.

Activity 2: *Clothes Rationing*

Find out about clothes rationing in the setting of our 1940s clothes shop. Can you work out what evacuees were allowed to take with them and how many coupons everything would cost?

Activity 3: *Gas Attacks*

Find out all about gas masks and gas attacks. Will they work out which mask is which? See real gas masks and try on a replica one.

Activity 4: *Q&A with WW2 Veterans*

This is an opportunity to talk to volunteers who lived through the Second World War. Encourage the class to think of questions that they can ask them. But remember, most of our volunteers were only young when the war started, so try and come up with some really good questions that they can answer.

We hope you enjoy your visit!

World War Two At Home (KS2) (3 Acts + Q&A) Notes for Teachers

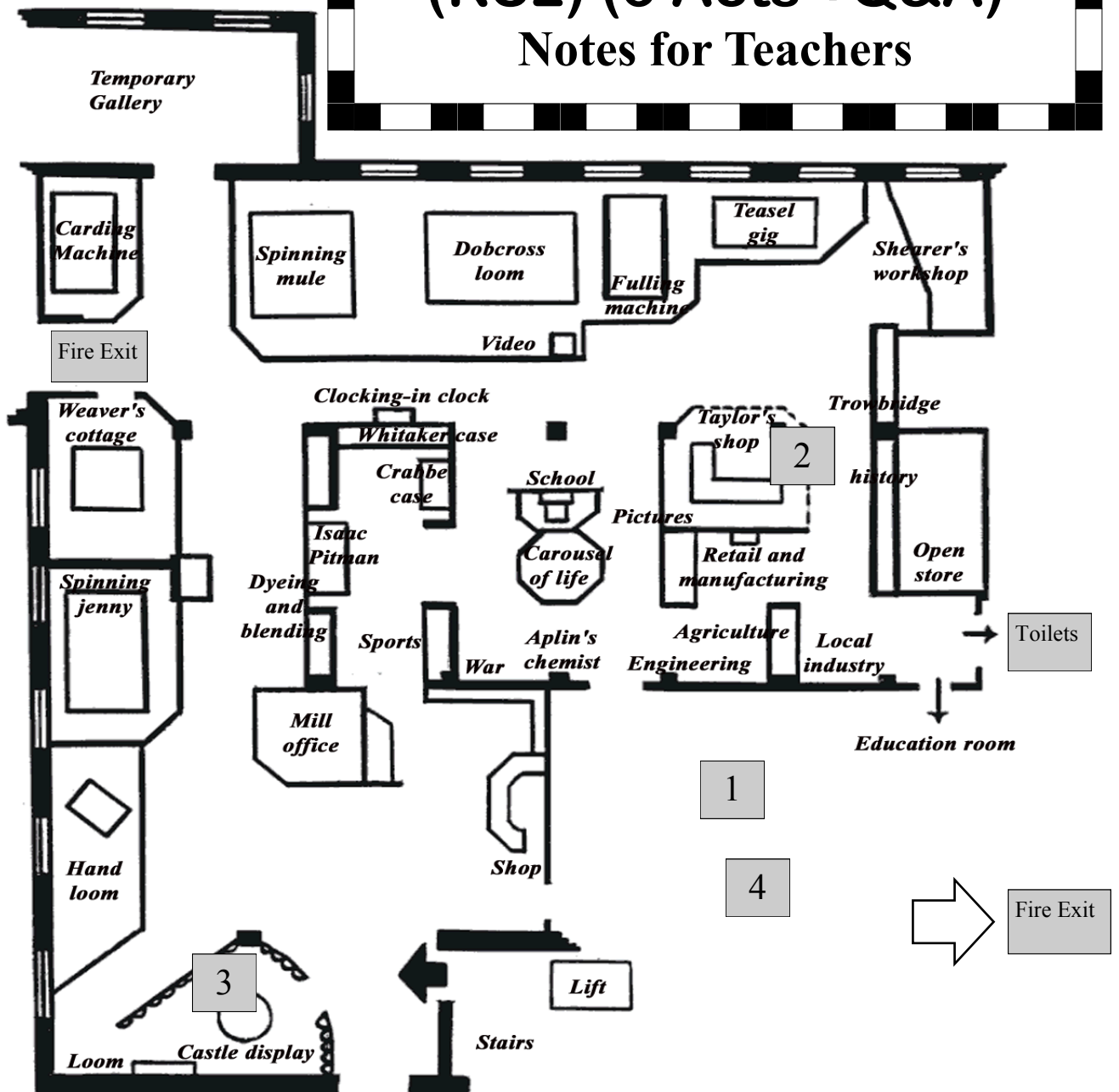

In the event of a fire, please direct your group to the nearest fire exit.
The stairs down to the shopping centre is not a fire exit and the lift should not be used.
Museum staff will be on hand to direct you.