

Changes in Trowbridge (KS2) (4 Acts)

Notes for Teachers

Before your visit we would be grateful if you could **divide the class into 4** roughly equal groups, each with an adult or teacher in charge. Please **number the groups 1 to 4**. Each adult will need a copy of the enclosed map/adult helper information sheet.

On arrival the children will be met and shown where to put their coats. They then need to **go to the activity which corresponds to their group number** (Group 1 goes to Activity 1 etc.)

At least one of the activities will be supervised by museum personnel or helpers; for all the others **easy instructions will be available** at the relevant location. The group needs to remain at its activity for about **20 minutes**; museum personnel will let you know when it's time to move on and which activity to go to next.

Activity 1: *Maps*

Use maps of Trowbridge town centre from the 1930s and today to find out how the town has changed

Activity 2: *Shopping*

Based in the reconstructed 1940s clothes shop explore how shopping has changed over the last 50 years

Activity 3: *Aerial Photograph*

Explore the giant aerial photograph of Trowbridge to see what has changed in the last 20 years.

Activity 4: *Then and Now*

Look at photographs of Trowbridge Market Place from the 1900s to the present day. Contrast and compare how the town centre has changed.

We hope you enjoy your visit!

Please copy this for TA's/parents/helpers

Changes in Trowbridge (KS2) (4 Acts)

Notes for Helpers

You will be in charge of a small group of children and will be escorting them around the museum. **Along with this sheet you will need a copy of the map** with numbers on (showing where each activity will take place).

Every 20 minutes the group will move to a different part of the museum to start a new activity. **There are 4 activities**, as detailed below. Museum personnel will let you know when it is time to move on and which activity to go to next. **Look for the arrows** to help you find your way to the next activity.

If you are with Group 1 you will start with Activity 1, Group 2, Activity 2 and so on. When it is time to move on, move your group to the activity with the next number (After Activity 4 you will move to Activity 1).

There will be a box or coloured wallet at each location. Please **read the instructions** and help the children to do the task.

Activity 1: *Maps*

Use maps of Trowbridge town centre from the 1930s and today to find out how the town has changed

Activity 2: *Shopping*

Based in the reconstructed 1940s clothes shop explore how shopping has changed over the last 50 years

Activity 3: *Aerial Photograph*

Explore the giant aerial photograph of Trowbridge to see what has changed in the last 20 years.

Activity 4: *Then and Now*

Look at photographs of Trowbridge Market Place from the 1900s to the present day. Contrast and compare how the town centre has changed.

We hope you enjoy your visit!.

Changes in Trowbridge (KS2) (4 Acts) Plan of Activities

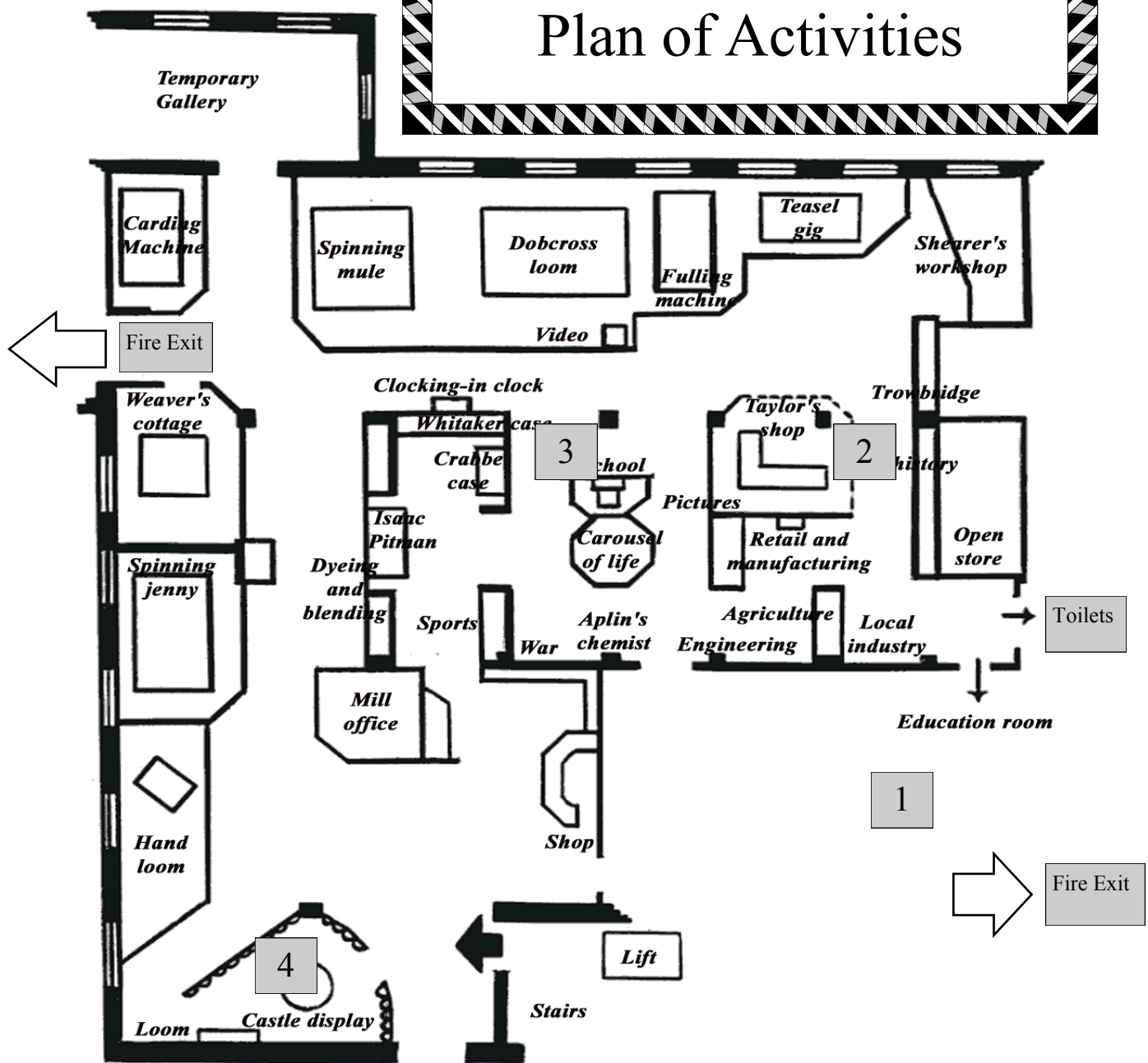

In the event of a fire, please direct your group to the nearest fire exit.
The stairs down to the shopping centre is not a fire exit and the lift should not be used.
Museum staff will be on hand to direct you.