

# Houses and Homes (KS1) (4 Acts)

## Notes for Teachers

Before your visit we would be grateful if you could **divide the class into 4** roughly equal groups, each with an adult or teacher in charge. Please **number the groups 1 to 4**. Each adult will need a copy of the enclosed map/adult helper information sheet.

On arrival the children will be met and shown where to put their coats. They then need to **go to the activity which corresponds to their group number** (Group One goes to Activity One etc.)

At least one of the activities will be supervised by museum personnel or helpers; for all the others **easy instructions will be available** at the relevant location. The group needs to remain at its activity for about **20 minutes**; museum personnel will let you know when it's time to move on and which activity to go to next.

### *Activity One: Norman Castle*

The children will find out what life was like in a Norman Castle, handling replica objects and trying on some costumes.

### *Activity Two: Tudor House*

Tudor Life is the subject of this activity. The children will be encouraged to talk about how houses were made at this time. They will also look at domestic objects and try on some Tudor hats and clothes.

### *Activity Three: Victorian Cottage*

This activity will show the children how people lived in Victorian England. They will examine a mock up of a weaver's cottage, try on some Victorian clothes and look at real and replica objects.

### *Activity Four: 1930's Semi-Detached*

This activity focuses on the 1930s/40s. The children will find out how people did their laundry and what they did for entertainment. Again, there will be some items of clothing to try on.

We hope you enjoy your visit!

# PLEASE PHOTOCOPY FOR PARENT-HELPERS

## Houses and Homes (KS1) (4 Acts)

### Notes for Helpers

You will be in charge of a small group of children and will be escorting them around the museum. **Along with this sheet you will need a copy of the map with numbers on** (showing where each activity will take place).

**Every 20 minutes**; the group will move to a different part of the museum to start a new activity. **There are 4 activities**, as detailed below. Museum personnel will let you know when it is time to move on and which activity to go to next. **Look for the arrows** to help you find your way to the next activity.

If you are leading Group 1 you will start at Activity 1, Group 2, Activity 2 and so on. When it is time to move on, move your group to the activity with the next number (after activity 4 you'll be going on to activity 1).

There will be a box or a coloured wallet at each location. **Please read the instructions** and help the children to complete the task.

#### Activity One: *Norman Castle*

The children will find out what life was like in a Norman Castle, handling replica objects and trying on some costumes.

#### Activity Two: *Tudor House*

Tudor Life is the subject of this activity. The children will be encouraged to talk about how houses were made at this time. They will also look at domestic objects and try on some Tudor hats and clothes.

#### Activity Three: *Victorian Cottage*

This activity will show the children how people lived in Victorian England. They will examine a mock up of a weaver's cottage, try on some Victorian clothes and look at real and replica objects.

#### Activity Four: *1930's Semi-Detached*

This activity focuses on the 1930s/40s. The children will find out how people did their laundry and what they did for entertainment. Again, there will be some items of clothing to try on.

We hope you enjoy your visit!

# Houses and Homes (KS1) (4 Acts)

## Notes for Teachers

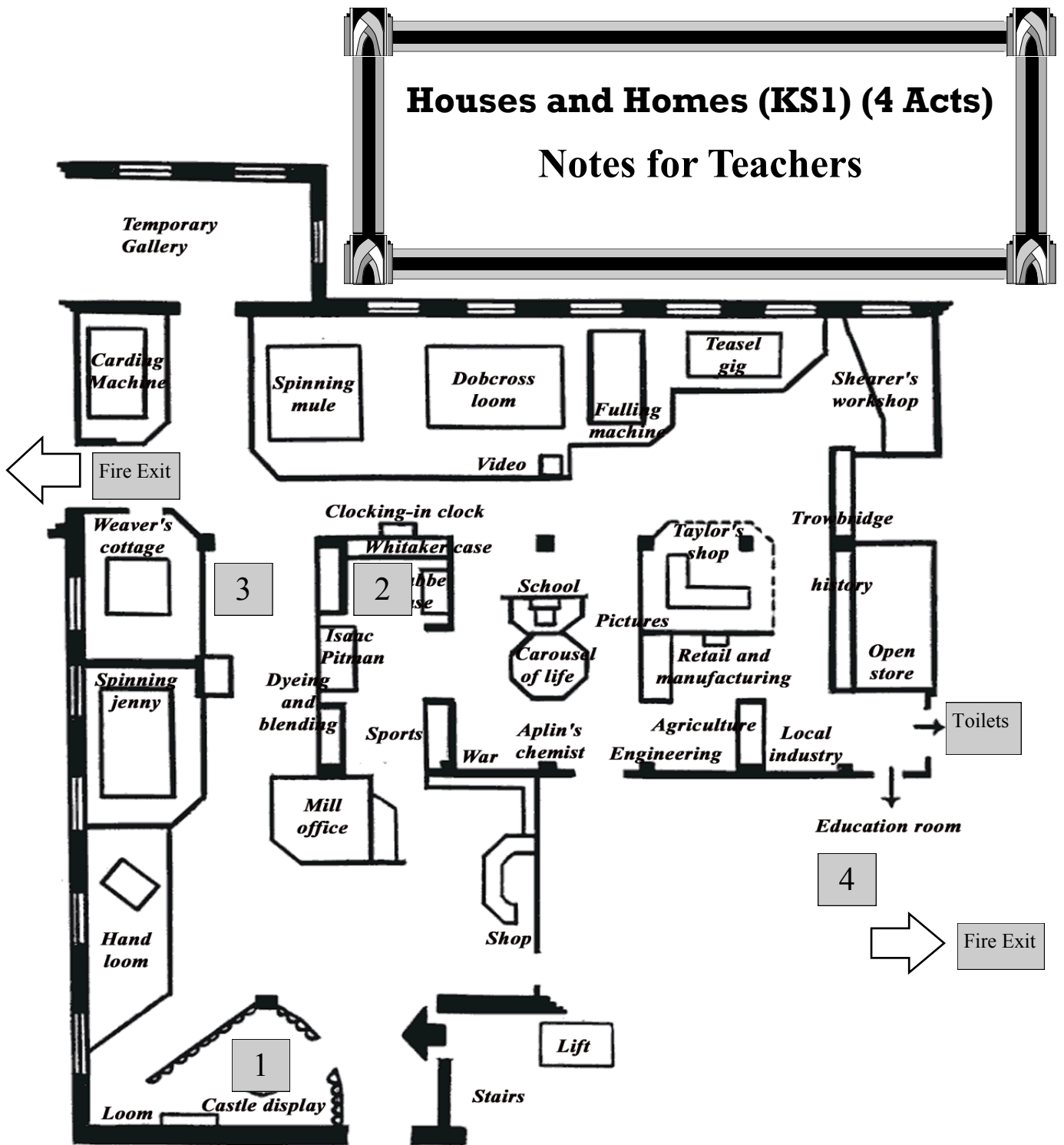

In the event of a fire, please direct your group to the nearest fire exit.  
The stairs to the shopping centre is not a fire exit and the lift should not be used.  
Museum staff will be on hand to direct you.